

# Ultrarroof380 Velux Installation

The complete guide to installing Velux onto an Ultrarroof380.

**PLEASE READ BEFORE FITTING**

## VELUX PRE INSTALLATION INFORMATION

Recommended tools -

FILM -

SEALING -

LADDERS -

FITTERS TIPS

- 1.
- 2.
- 3.

## VELUX INSTALLATION ON ULTRAROOOF380

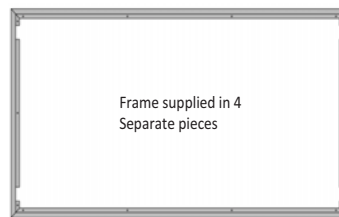

Frame supplied in 4  
Separate pieces

NRCK01/02/04/06  
Roof vent frame supplied by Ultraframe.

To be used in conjunction with the GGL/CK roof window and EDI flashing installation guides supplied by Velux.

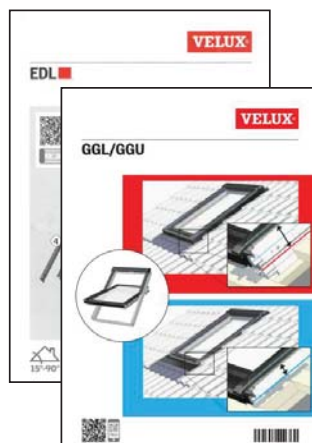

Perform adhesive

NRFK001/002  
Supplied by Ultraframe.



Butyl flashing  
strips



Stainless steel  
Screws + screw caps

To be used in conjunction with Velux EDL flashing kit (NOT supplied by Ultraframe).

# VELUX INSTALLATION ON ULTRAROOF380

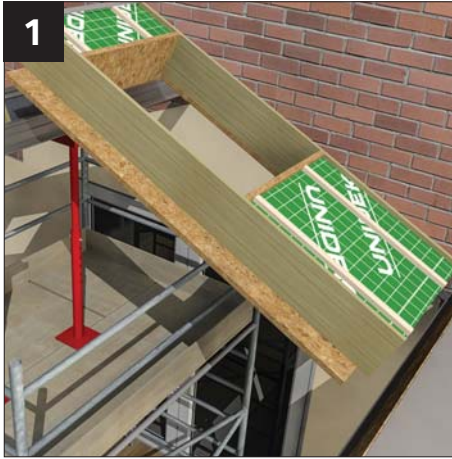

**1**  
Fit the Velux support panel (with the extended internal OSB). This must be installed before the other panels.



**2**  
Continue fitting the panels following the layout sheet supplied.



**2**  
After fitting the OSB external panels, drill marking holes from the inside of the roof.



**4**  
Using the marking holes as a guide, cut out the aperture for the Velux frame.



**5**  
Test fit the Velux frame with the brackets fitted. Remove material required to allow the brackets to sit flush on the OSB surface.

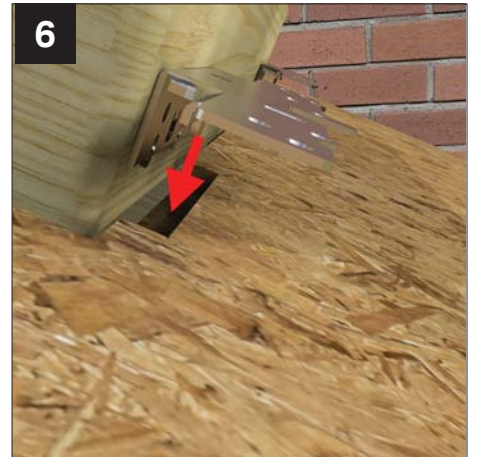

**6**  
Fit the frame.



**7**  
Fix frame to OSB.

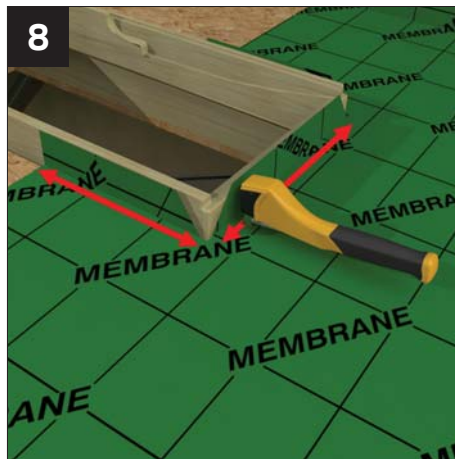

**8**  
Fit lower felt membrane. Cut the felt flush with the left and right of the frame to cover the lower edge as shown.



**9**  
Continue fitting the membrane allowing it to extend up the sides of the frame as shown.

# VELUX INSTALLATION ON ULTRAROOF380



10 Lay upper membrane section and cut to fit around aperture



11 Ensure membrane is fitted neatly against the aperture and staple in position and trim.

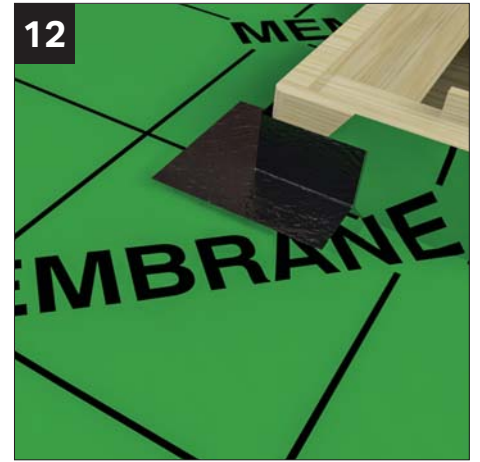

12 Seal upper corners with tape.

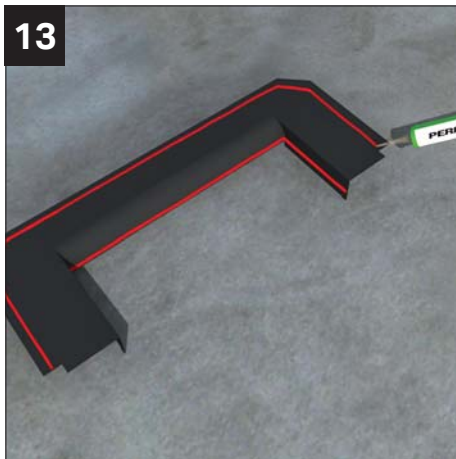

13 Apply Perform adhesive to the underside of the flashings. Lower panel shown.

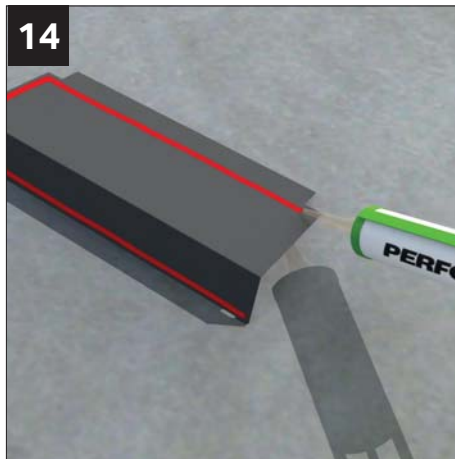

14 Apply Perform adhesive to the underside of the flashings. Side panel shown.

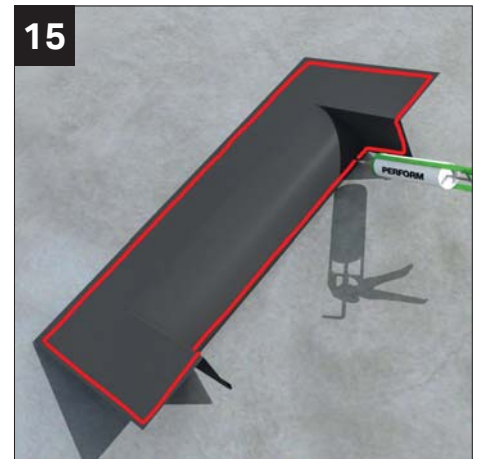

15 Apply Perform adhesive to the underside of the flashings. Upper panel shown.

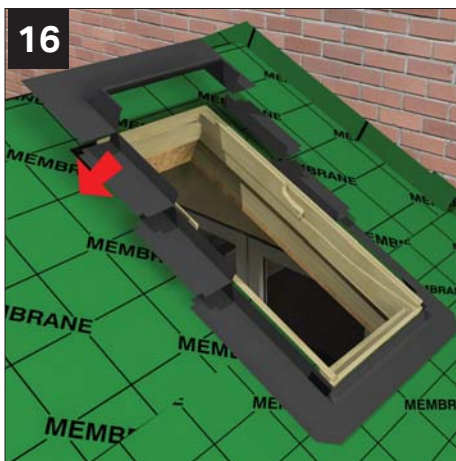

16 Fit overlapping flashings following supplied Velux guide.



17 Apply the supplied aluminium backed butyl tape. Fit the SIDES first followed by the top to ensure a good seal.



18 Fit the tiles following the relevant information shown on pages 28 to 33. The tiles should be centred around the Velux with a 50mm gap to the left and right sides.

## VELUX INSTALLATION ON ULTRAROOF380



Finally fit the supplied 4 part tile frame covering the cut edges of the roof tiles.



Secure the frame in position using the screw and cap supplied.



Finally, insert the glazed opener following Velux installation guide.

[www.ultraframetrade.co.uk](http://www.ultraframetrade.co.uk)

**Ultra**frame  
Transforming light and space

**Job No.: 3679 10/17 V1 NRVG001**

It is Ultraframe's policy to continually seek to improve its products, processes and services, and we reserve the right to change specifications without prior notice. Ultraframe is a trading name of Ultraframe (UK) Limited.